

Original BMW Accessories. Installation Instructions.



M Aerodynamic Package Retrofit BMW X1 (E84)

Retrofit kit number

51 95 2 297 708 Basic package

Front bumper trim

51 11 8 039 388 Primed front bumper trim
51 11 8 039 479 Primed front bumper trim (for cars with SA 508)
51 11 8 050 464 Primed front bumper trim (for cars with SA 502)
51 11 8 050 636 Primed front bumper trim (for cars with SA 502 and SA 508)

Rear bumper trim

51 12 8 039 897 Primed rear bumper trim
51 12 8 039 898 Primed rear bumper trim (for cars with SA 507 and SA 508)

Rear bumper finisher

51 12 8 038 991 Rear bumper finisher (for cars with double-fluted tailpipe)
51 12 8 038 993 Rear bumper finisher (for cars with single-fluted tailpipe)

Installation time

The installation time is **approx. 4 hours**. This may vary depending on the condition of the car and the equipment in it.

The time required for painting is around **5 hours**. The actual time spent on painting must be calculated based on the features and condition of the car. The total costs of the painting time must be taken into account when calculating the retrofitting costs.

Important information

These installation instructions are primarily designed for use within the BMW dealership organisation and by authorised BMW service companies.

In any event, the target group for these installation instructions is specialist personnel trained on BMW cars with the appropriate specialist knowledge.

All work must be completed using the latest BMW repair manuals, wiring diagrams, servicing manuals and work instructions, in a rational order, using the prescribed tools (special tools) and observing current health and safety regulations.

If you experience installation or function problems, restrict troubleshooting to approx. 0.5 hours for mechanical work and 1.0 hour for electrical work.

To avoid unnecessary extra work and/or costs, send an inquiry straight away to the technical parts support team via the Aftersales Assistance Portal (ASAP).

Quote the following information:

- Chassis number,
- Retrofit kit part number,
- A detailed description of the problem,
- Any work already carried out.

Do not archive the hard copy of these installation instructions since daily updates are provided via ASAP!

Pictograms



Denotes instructions that draw your attention to dangers.



Denotes instructions that draw your attention to special features.

◀ Denotes the end of the instruction or warning text.

Installation information

Ensure that the cables and/or lines are not kinked or damaged as you install them in the car. Costs arising from this will not be reimbursed by BMW AG.

Additional cables/lines that you install must be secured with cable ties.

Some of the installation steps are shown only on the right-hand side of the car. Proceed in the same way on the left-hand side of the car.

All pictures show LHD cars; proceed accordingly on RHD cars.

All retrofitted components must be at room temperature when they are being installed.

In order to avoid damage, all installation sites must be free of coarse dirt.

Painting instructions

Check that all the parts fit accurately on the car before painting them. Primed parts must be pre-treated accordingly before painting.

The BMW painting instructions must be observed (see ISTA No. 99 00 ...).

Ordering instructions

The basic package must be ordered for the applicable series and includes all assembly parts and the side sill covers **Y** and **Z**, regardless of the car's features.

Front bumper trim **A** is not included in the basic package and must be ordered separately on a vehicle-specific basis (see EPC for part number and further information).

Rear bumper trim **U** is not included in the basic package and must be ordered separately on a vehicle-specific basis (see EPC for part number and further information).

Rear bumper finisher **V** is not included in the basic package and must be ordered separately on a vehicle-specific basis (see EPC for part number and further information).

List of special equipment

The following special equipment must be taken into consideration when installing the retrofit kit:

SA 235	Removable trailer tow hitch
SA 502	Headlight cleaning system
SA 507	Park Distance Control (PDC) rear
SA 508	Park Distance Control (PDC) front and rear

Special tools required

00 9 325, Trim wedges

Table of contents

Section	Page
1 Front bumper trim parts list	4
2 Rear bumper trim parts list	6
3 Side sill covers, wheel arch finishers and sill trims parts list	7
4 Preparatory work	8
5 Assembling and fitting the front bumper trim	9
6 Fitting the rear bumper trim	12
7 Fitting the side sill covers, wheel arch finishers and sill trims	13
8 Concluding work and coding	14

1. Front bumper trim parts list

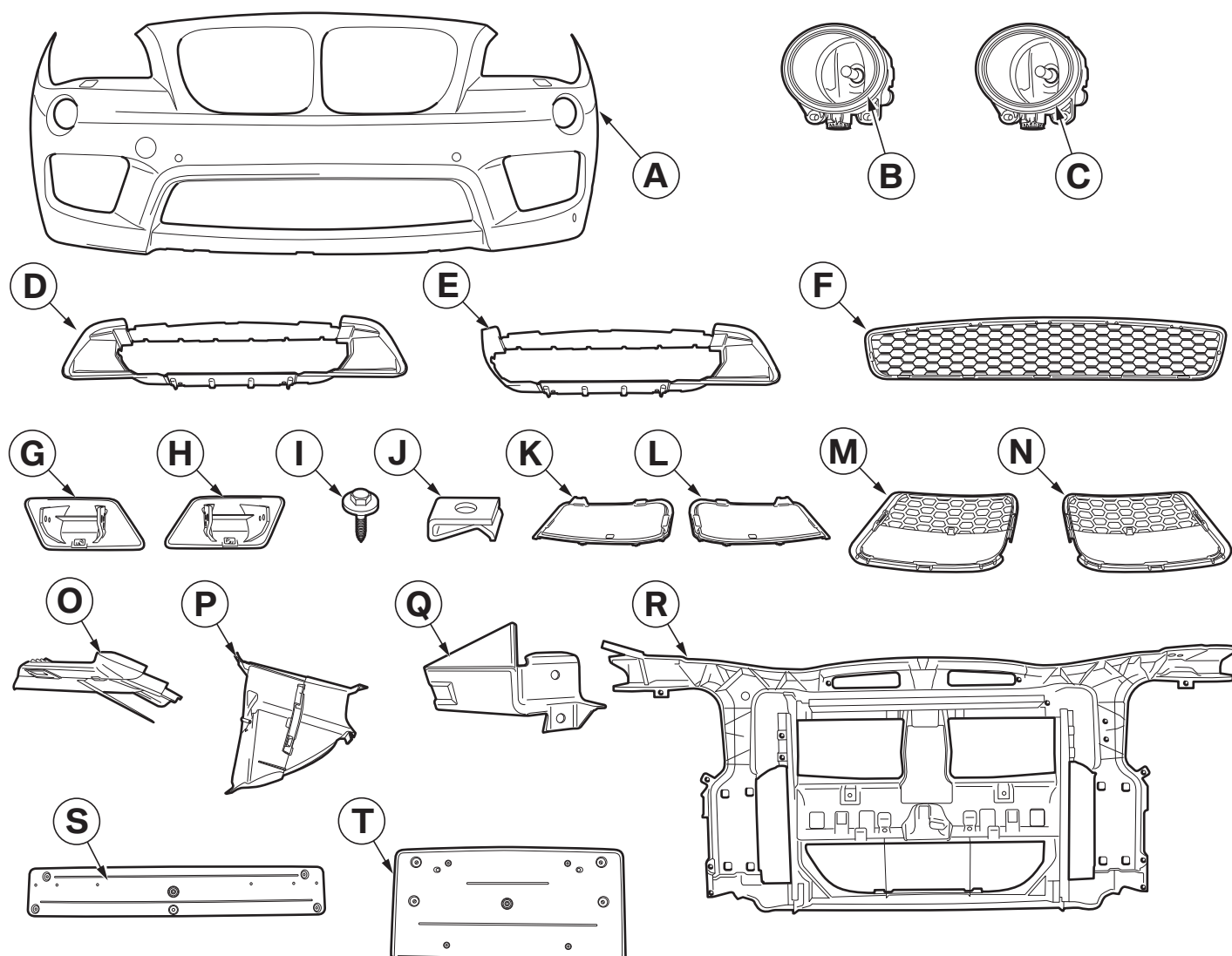

084 0174 Z

Legend

- A** Front bumper trim
- B** Fog light, left
- C** Fog light, right
- D** Front panel adapter (only for cars without swapped-out engine oil cooler)
- E** Front panel adapter (only for cars with swapped-out engine oil cooler)
- F** Air inlet grille, centre
- G** Left protective cap (only for cars with SA 502)
- H** Right protective cap (only for cars with SA 502)
- I** Screw (5 x)
- J** Sheet metal nut (5 x)
- K** Left grille cover
- L** Right grille cover
- M** Air inlet grille, left
- N** Air inlet grille, right

1. Front bumper trim parts list

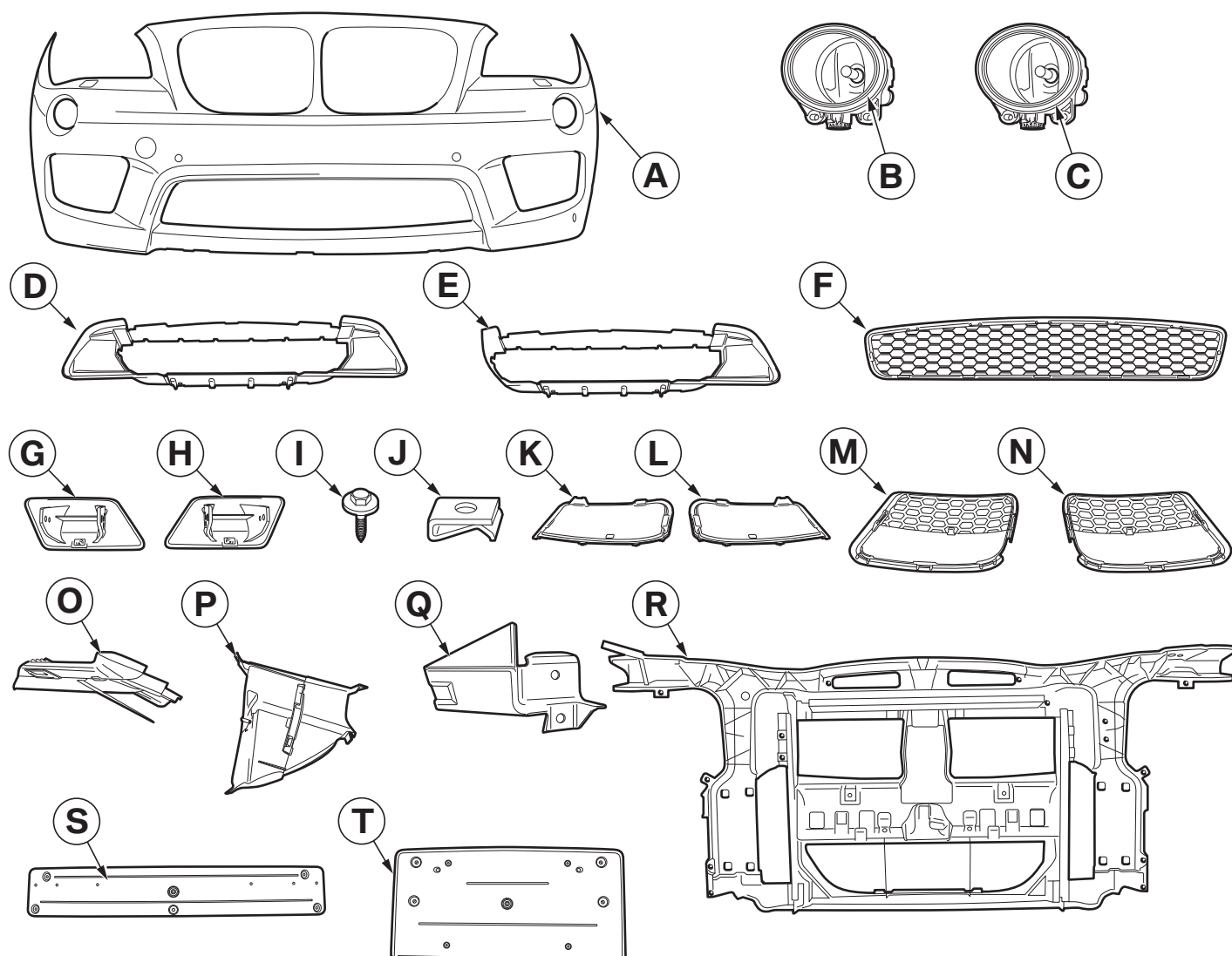

084 0174 Z

Legend

- O** Front air guide (only for cars with swapped-out engine oil cooler)
- P** Engine oil cooler air guide (only for cars with swapped-out engine oil cooler)
- Q** Air guide holder (only for cars with swapped-out engine oil cooler)
- R** Front panel
- S** Number plate carrier (only for ECE models)
- T** License plate carrier (only for USA/JAP models)

2. Rear bumper trim parts list

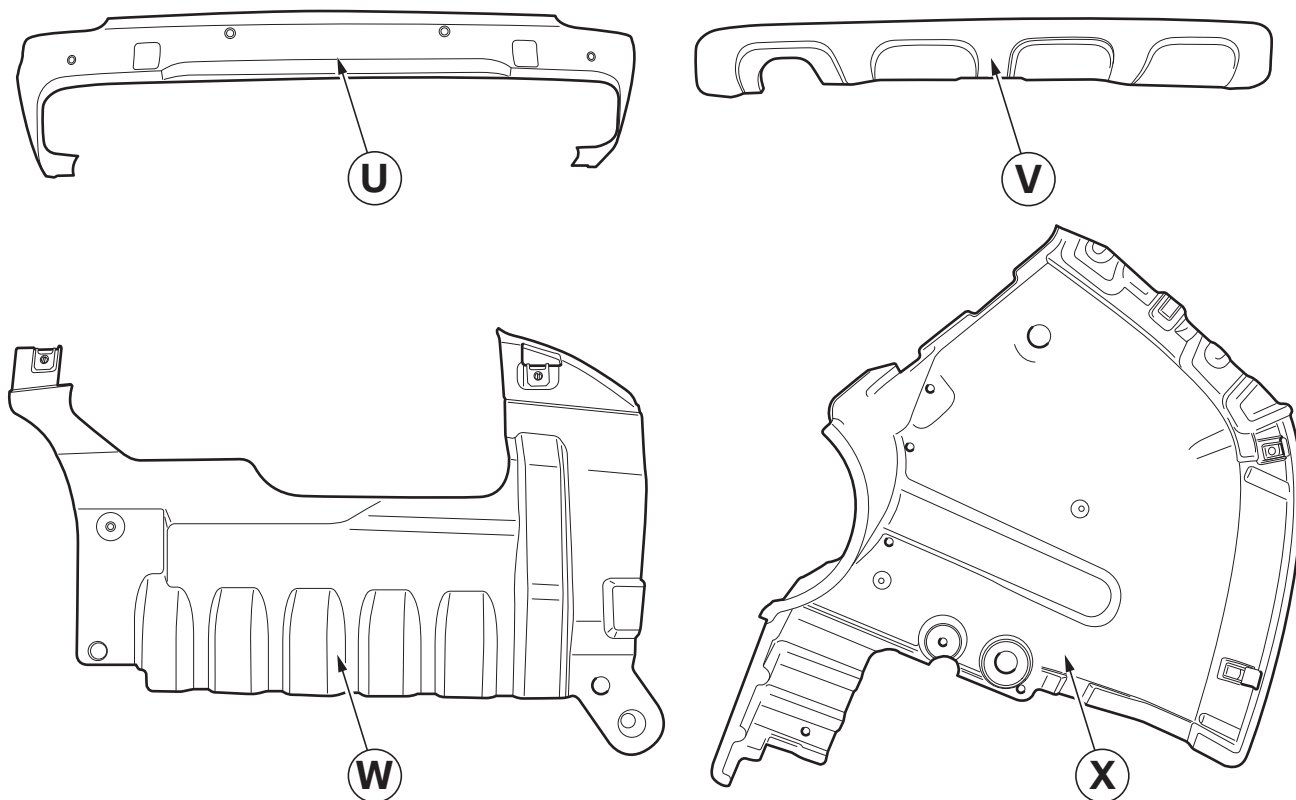

084 0175 Z

Legend

- U** Rear bumper trim
- V** Rear bumper finisher
- W** Bottom centre guide
- X** Right cover

3. Side sill covers, wheel arch finishers and sill trims

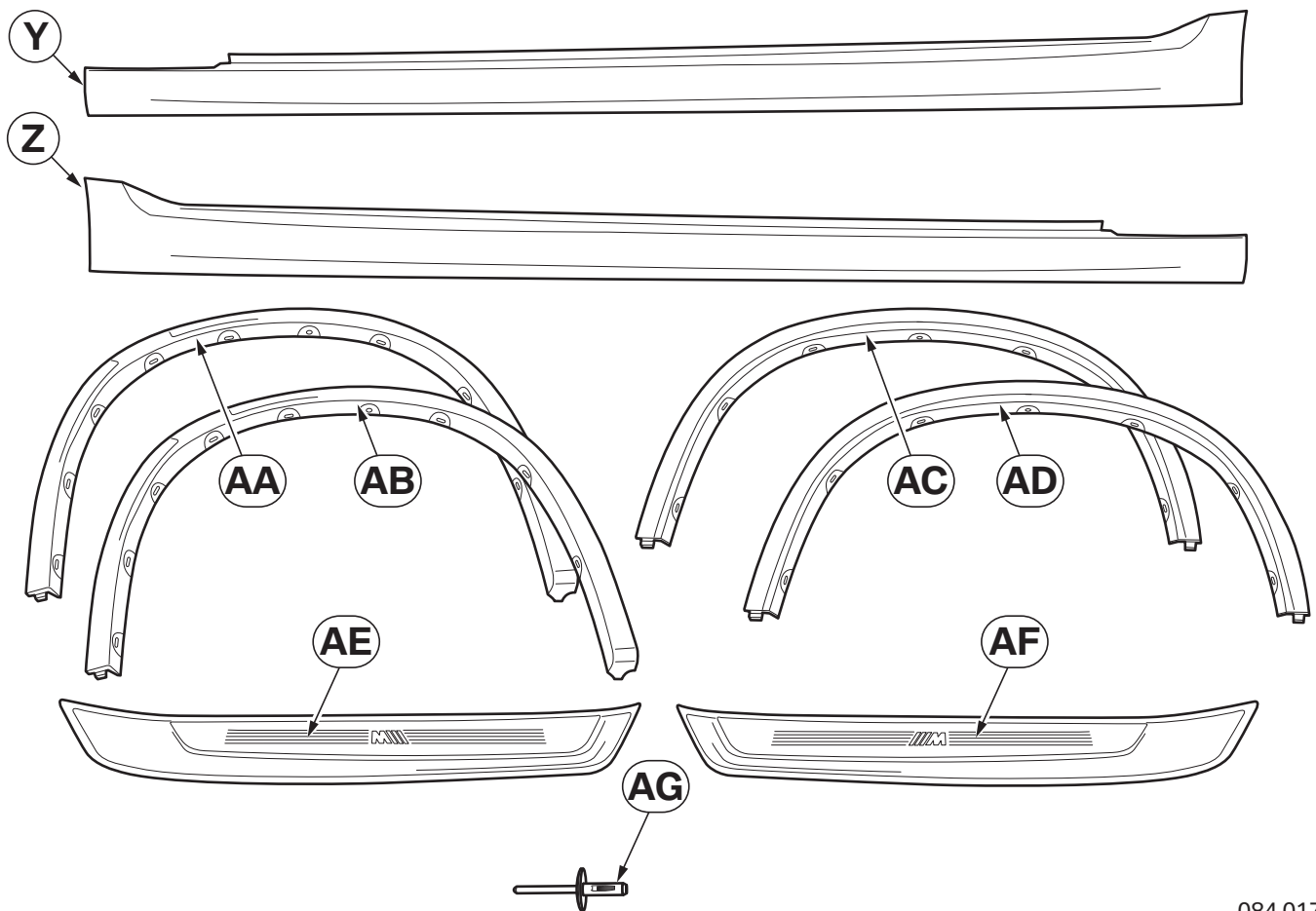

084 0176 Z

Legend

- Y** Left side sill cover
- Z** Right side sill cover
- AA** Front left wheel arch finisher
- AB** Front right wheel arch finisher
- AC** Rear left wheel arch finisher
- AD** Rear right wheel arch finisher
- AE** Front left sill trim
- AF** Front right sill trim
- AG** Expanding rivet (32 x)

4. Preparatory work

	ISTA No.
Conduct a brief test	---
Disconnect the negative pole of the battery	12 00 ...
The following components must be removed first of all (all securing material is reused)	
Front bumper trim (existing PDC sensors are reused)	51 11 157
Centre front decorative grille, left and right	51 13 001
Front shock absorber	---
Holder for bottom front bumper trim	51 11 050
Front panel	41 33 040
Left and right side sill cover	51 71 447
Front and rear wheel arch finisher	51 71 ...
Trim cover on the front left and right sill	51 71 065
Finisher on the lower rear bumper trim	51 12 ...
Rear lower bumper trim (existing PDC sensors are reused)	51 12 160
Rear bumper trim	51 12 156
Underbody panelling (active carbon filter)	51 75 ...
Bottom centre guide	51 12 ...
Also on cars with swapped-out engine oil cooler	
Engine oil cooler air guide	---

5. Assembling and fitting the front bumper trim

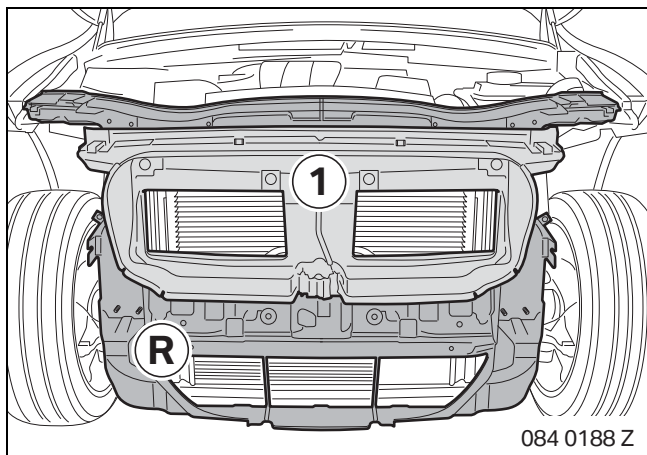

Install front panel **R** using the existing fastening material (see ISTA 41 33 040).

Install the existing air guide (1).

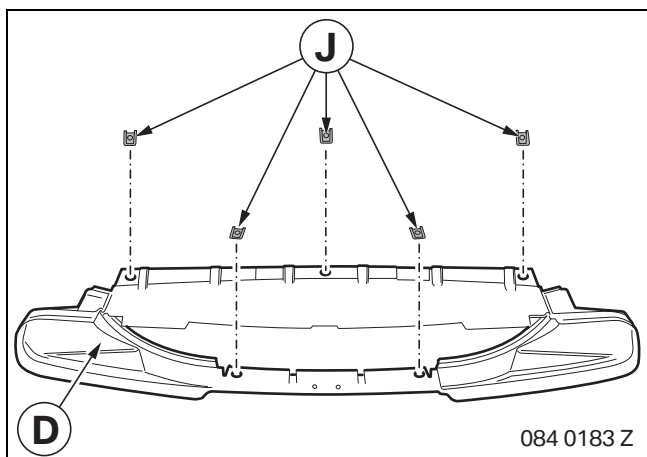

Only cars without swapped-out engine oil cooler
Slide sheet metal nut **J** onto front panel adapter **D**.

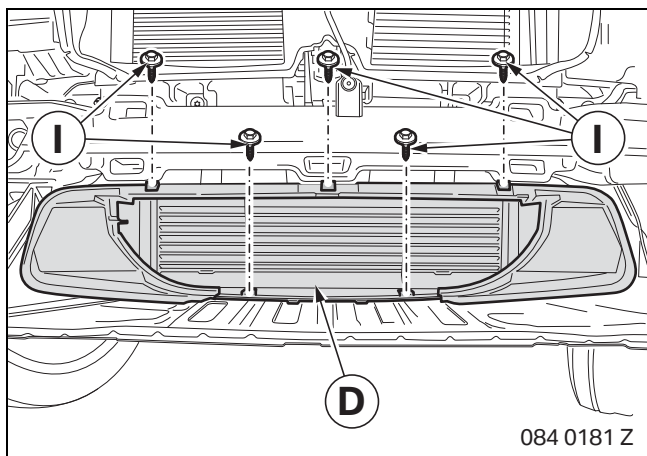

Secure front panel adapter **D** using screws **I** to the previously-installed front panel.

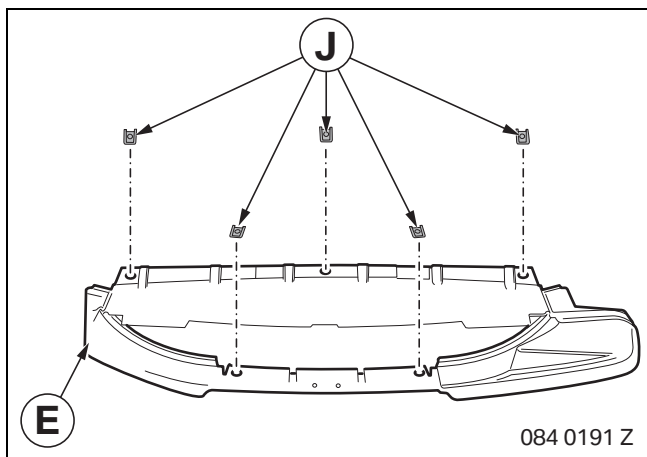

Only cars with swapped-out engine oil cooler
Slide sheet metal nut **J** onto front panel adapter **E**.

5. Assembling and fitting the front bumper trim

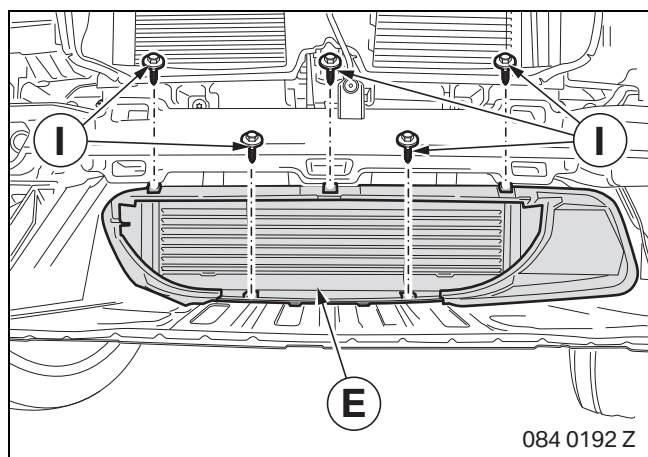

Secure front panel adapter **E** using screws **I** to the previously-installed front panel.

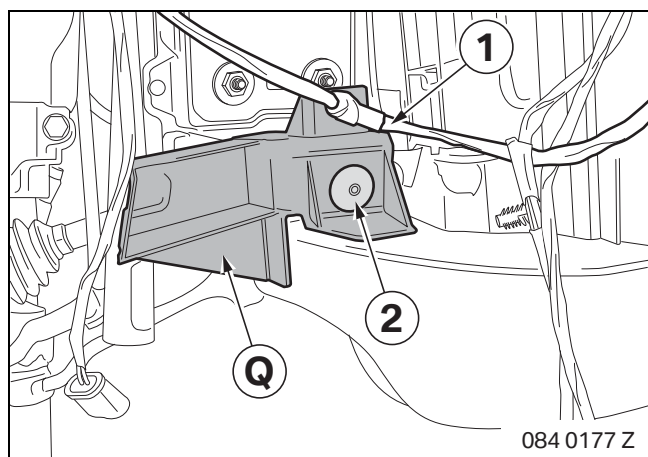

▶ The arrangement of the air guides must be observed according to the engine and country version. ◀

Unclip the cable on the car (1).

Install right air guide holder **Q** using the expanding rivet (2). Clip the cable (1) into right air guide holder **Q**.

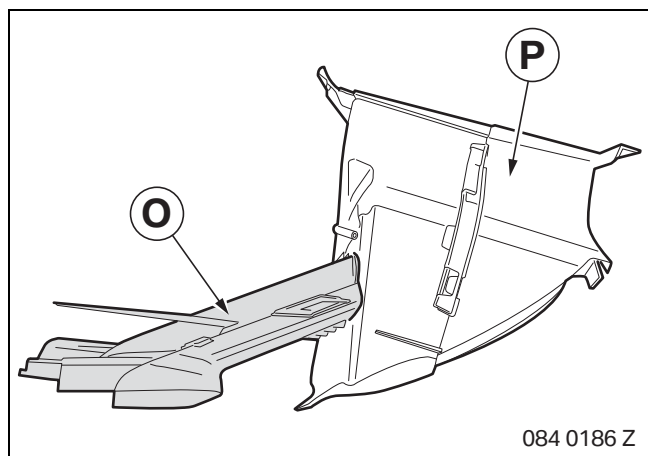

Clip front air guide **O** into engine oil cooler air guide **P**.

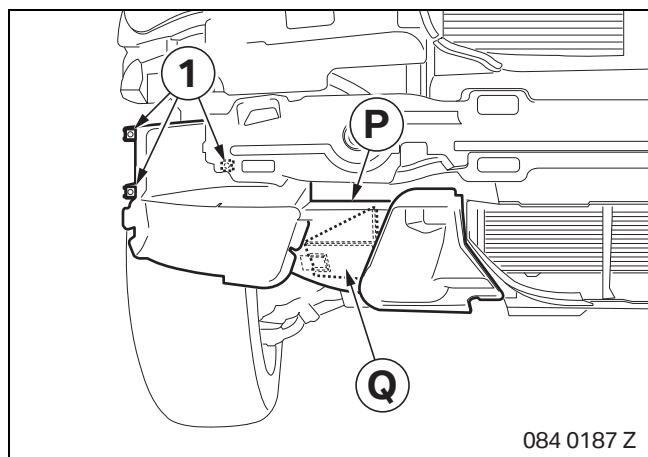

Insert engine oil cooler air guide **P** into air guide holder **Q** and secure to the engine oil cooler using the existing fastening material (1).

5. Assembling and fitting the front bumper trim

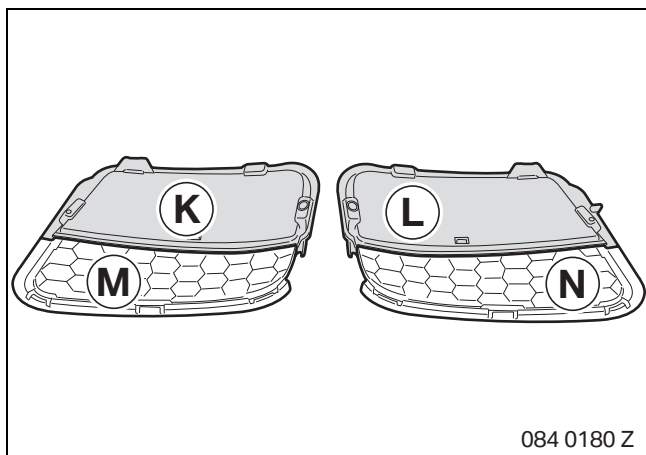

Only cars without swapped-out engine oil cooler

⏏ Covers **K** and **L** are not installed on cars with swapped-out engine oil coolers. ◀

Clip covers **K** and **L** onto left air inlet grille **M** and right air inlet grille **N**.

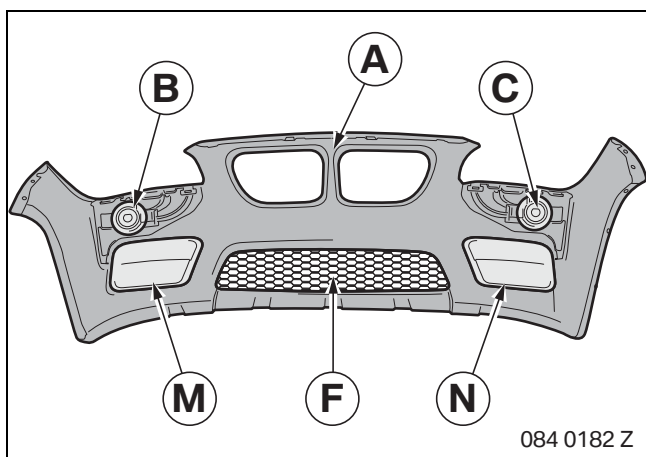

All cars

Clip centre grille **F**, left air inlet grille **M** and right air inlet grille **N** into bumper trim **A**.

Install left fog light **B** and right fog light **C** using the existing fastening material (see ISTA 63 170 70).

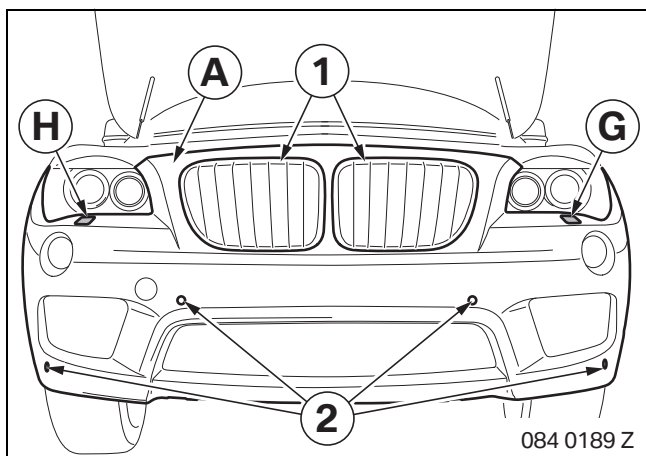

Clip the existing left and right decorative grille (1) into bumper trim **A**.

Only cars with SA 508

Install the existing PDC (2) sensors into bumper trim **A**.

All cars

Fit bumper trim **A** (see ISTA 51 11 157).

Only cars with SA 502

Fit protective cap **G** and protective cap **H** (see ISTA 51 11 ...).

6. Fitting the rear bumper trim

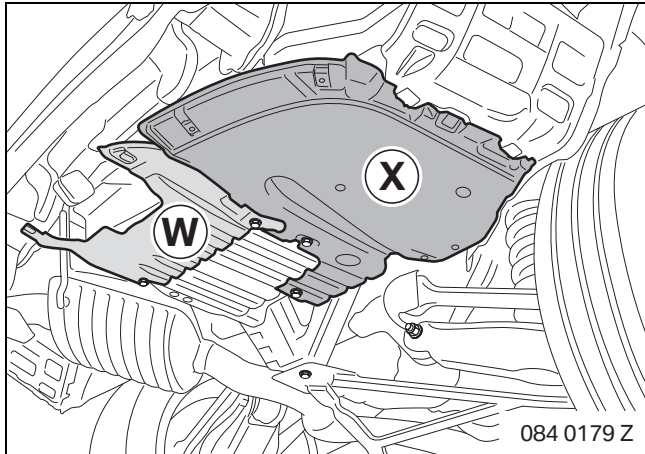

Fit centre bottom guide **W** and right cover **X** using the existing fastening material.

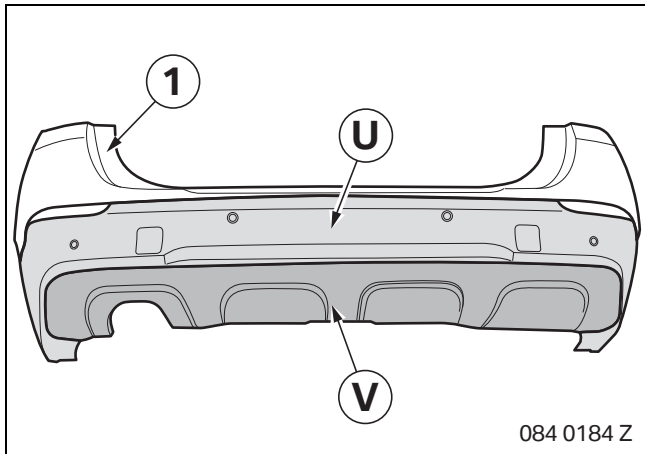

Fit rear bumper trim **U** onto the existing rear bumper trim **1** (see ISTA 51 12 160).

Fit rear bumper finisher **V** onto rear bumper trim **U** (see ISTA 51 12 160).

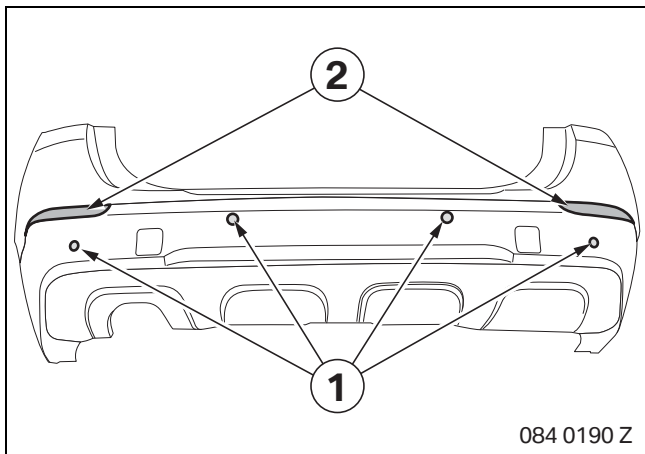

Cars with SA 507 or SA 508 only

Install the existing PDC sensors **1** (see ISTA 51 11 ...).

All cars

Clip in the existing reflectors **2**.

Fit bumper trim (see ISTA 51 12 160).

7. Fitting the side sill covers, wheel arch finishers and sill trims

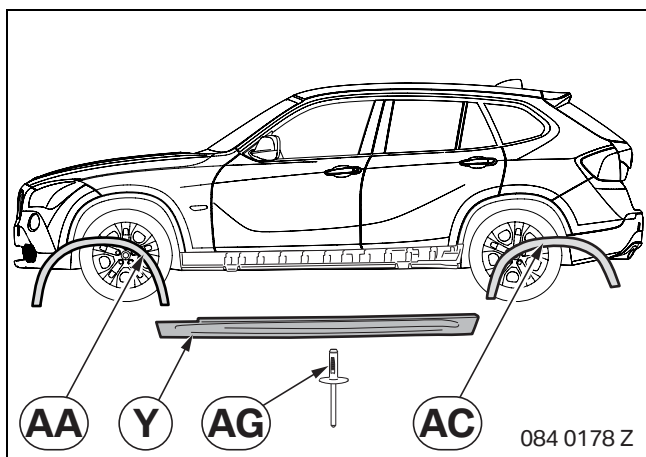

▶ The installation process is shown only on the left-hand side of the car; proceed in the same way on the right-hand side of the car. ◀

Fit left sill cover **Y** using the existing fastening material (see ISTA 51 71 447).

Fit front left wheel arch finisher **AA** and rear left wheel arch finisher **AC** using expanding rivet **AG** (see ISTA 51 71 ...).

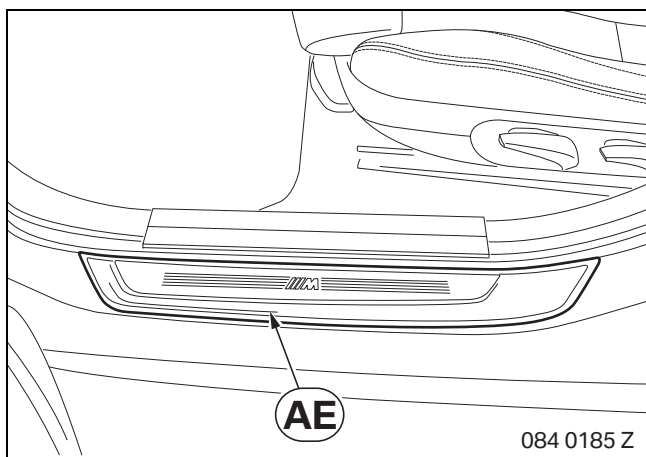

▶ The installation process is shown only on the left-hand side of the car; proceed in the same way on the right-hand side of the car. ◀

Fit front left sill trim **AE** (see ISTA 51 71 065).

8. Concluding work and coding

The retrofit system does not require programming/coding.

- Connect the battery
- Adjust the fog lights as described in ISTA 63 10 004
- Adjust the fog lights as described in ISTA 63 10 014
- Check the function of the headlight cleaning system (only cars with SA 502)
- Check the function of the Park Distance Control (only cars with SA 508)
- Fit the number plate required by the Police using number plate carrier **S** or **T** as described in ISTA 51 11
- Re-assemble the car appropriately